

Etac Backrest Upholstery Clean

SKU: [80209225](#)

Adjustable. Washing at max 60°C (140° F)

Price: [SGD \\$134.40](#)



Trunk Support Swift Mob/Clean

SKU: [80209509](#)

Offers a soft side support and facilitates positioning in the chair. Adjustable in width. Material: Polyester fabric, Velcro, polyethylene.

Price: [SGD \\$137.40](#)



Etac Crossbar Clean

SKU: [80209246](#)

Attached to the arm supports. Material: Aluminium, cellular polyethylene, polypropylene. Can not be used in combination with: 80209228, 80209237 and 80209226.

Price: [SGD \\$148.50](#)



Etac Clean/Swift Chest Harness

SKU: [80209442](#)

Easy to adjust and attach around the straps of the back support upholstery. Use with a hip belt is recommended.

Material: Polyester

Price: [SGD \\$67.80](#)



Etac Clean/Swift Positioning Belt

SKU: [80209440](#)

Easy to adjust with a plastic buckle. Attaches around the back tubes in the rear with velcro straps.

Material: Polyester

Price: [SGD \\$67.80](#)



Etac Clean Safety Belt Clean

SKU: [80209034](#)

Adjustable in length. Attach to back support. Always use together with a positioning belt. Material: Polyester. Can not be used in combination with: 80209225.

Price: [SGD \\$67.80](#)



Etac Clean Comfort Kit

SKU: [80209237](#)

Includes both Comfort Seat Soft and Comfort Cover. Cleaning max. 60° C (140 °F) or with alcohol wipe. Can not be used in combination with: 80209225 and 80209246.

Price: [SGD \\$458.40](#)



Etac Comfort Cover Clean

SKU: [80209228](#)

A soft back support with integrated arm support pads. Material: polyethylene. Cleaning max. 60° C (140 °F) or with alcohol wipe. Can not be used in combination with: 80209225 and 80209246.

Price: [SGD \\$229.20](#)



Etac Comfort Seat Clean with smaller opening

SKU: [80209301](#)

A soft contoured seat in two versions, small opening: W 15 cm (6") or narrow opening: W 18 cm (7"). Material: polyurethane. Cleaning max. 85° C (185°F) or with alcohol wipe.

Price: [SGD \\$218.40](#)



Etac Soft Comfort Seat Clean, Height 2cm

SKU: [80209517](#)

A low and very soft comfort seat for Etac Clean. Height 2 cm. Opening width 18 cm. Material: Polyurethane. Cleaning at max 85°C or with alcohol wipe.

Price: [SGD \\$ 112.20](#)



Etac Lid for seat Clean black

SKU: [80209247](#)

When a complete seat is required. Material: Polyurethane. Cleaning max. 85° C (185°F) or with alcohol wipe.

Price: [SGD \\$231.30](#)



Etac Pan incl. lid with handle grey Clean

SKU: [80209255](#)

Material: Polypropylene.

Price: [SGD \\$91.50](#)



Etac Pan holder grey Clean / Swift

Mobil

SKU: [80209257](#)

Fits both pan, bedpan and regular hospital pans with a thin rim.

Price: [SGD \\$34.20](#)



Etac Bucket with handle and lid grey

SKU: [80209265](#)

Traditional bucket that is used with a bucket holder.

Material: Polypropylene

Price: [SGD \\$61.20](#)



Etac Bucket holder grey Clean/ Swift

Mobil

SKU: [80209258](#)

Fits Bucket with handle and lid and other buckets with a thick rim. Material: Polypropylene

Price: [SGD \\$34.20](#)



Etac Extension for low pan/bucket

SKU: [80209259](#)

Fitted to the pan/bucket holder. Lowers the pan/bucket holder with 6 cm (2½"). Material: Polypropylene.

Price: [SGD \\$16.80](#)



Etac Disposable Pans 50 pcs

SKU: [80209282](#)

Strong and firm.

Price: [SGD \\$173.40](#)



Etac Holder Disposable Pan Clean grey

SKU: [80209229](#)

Fits Disposable pan.

Price: [SGD \\$131.70](#)



Etac Rear Wheel Adapter Clean white

SKU: [80209305](#)

55cm Only

Material: Aluminium, polyamide.

Price: [SGD \\$706](#)



Etac Swift Castor 125 Lockable White Pair Front

SKU: [84006137](#)

12.5cm Diameter

Castors with ball, bearings: Polyamide/TPE/Stainless steel tubing

Price: [SGD \\$115.50](#)

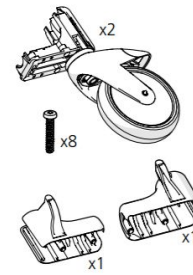

80209513, 80209515, 84006133, 84006135,
84006137, 84006139

Etac Swift Castor 125 Lockable White Pair Rear

SKU: [84006138](#)

12.5cm Diameter

Castors with ball, bearings: Polyamide/TPE/Stainless steel tubing

Price: [SGD \\$115.50](#)

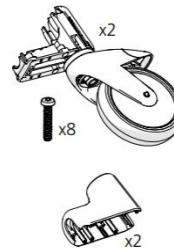

80209514, 80209516, 84006134, 84006136,
84006138, 84006140