



Foshan hongfeng co., ltd

HF808 rotation /raising/ alternating mattress system



weight (Kg)	20Kg	50Kg	120Kg	150Kg	180Kg
low pressure (mmHg)	30	35	40	45	50
high pressure (mmHg)	30	40	60	70	80

Alarm:	<p>Power failure long "Bi..." alarm .</p> <p>Air leakage (low pressure) alarm :(1.The air pump operates continuously for 60 minutes when it is turned on (when the initial start-up pressure exceeds 27mmhg, it will enter into alternation automatically, and when the pressure does not exceed 27mmhg, other function keys not available to use , and can only be realized when the pressure reaches 27mmhg. When the pressure is lower than 23mmhg, it is judged as low pressure of air leakage and intermittent (Bi,Bi...) Alarm sound . 2. When it is not charged to 27mmhg within 4 minutes when entering B pipe from A (B to A) in normal alternation, it will give out alarm (Bi Bi...) The air leakage alarm will sound. After the alarm is removed, the 4-minute alarm model test room will be used again).</p>
Cycle time :	<p>air tube output control mode: after starting the machine, the motor moves to the short bayonet, 2 pipes, 1 and 2 gas pipes circulate. When starting the air valve, go to the small bayonet and 2 pipes to inflate at the same time, and when the air pressure is charged to 27mmhg, then carry out the air exchange circulation. Cycle time (6 minutes / half circle: 1 minute for the small bayonet and 5 minutes for the large bayonet). 9 minutes / half circle: 1 minute for small bayonet and 8 minutes for large bayonet. 12 minutes / half circle: 1 minute for small bayonet and 11 minutes for large bayonet).</p>

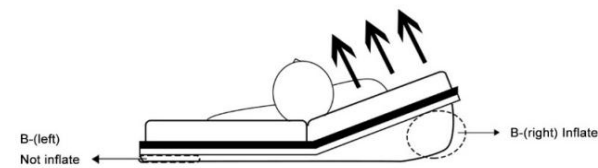
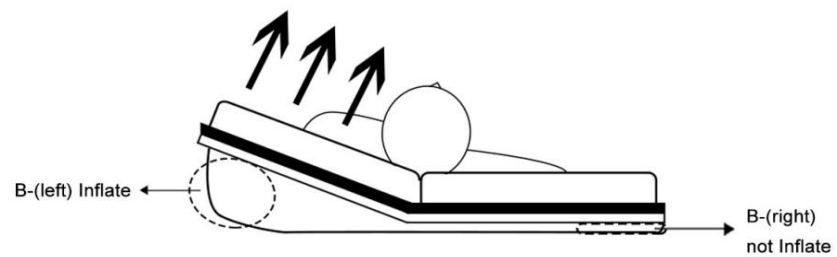
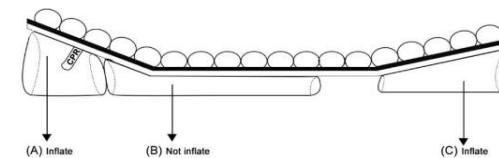
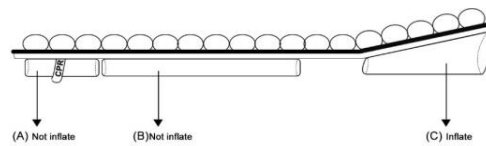
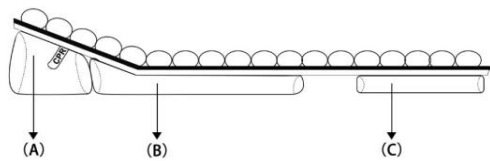
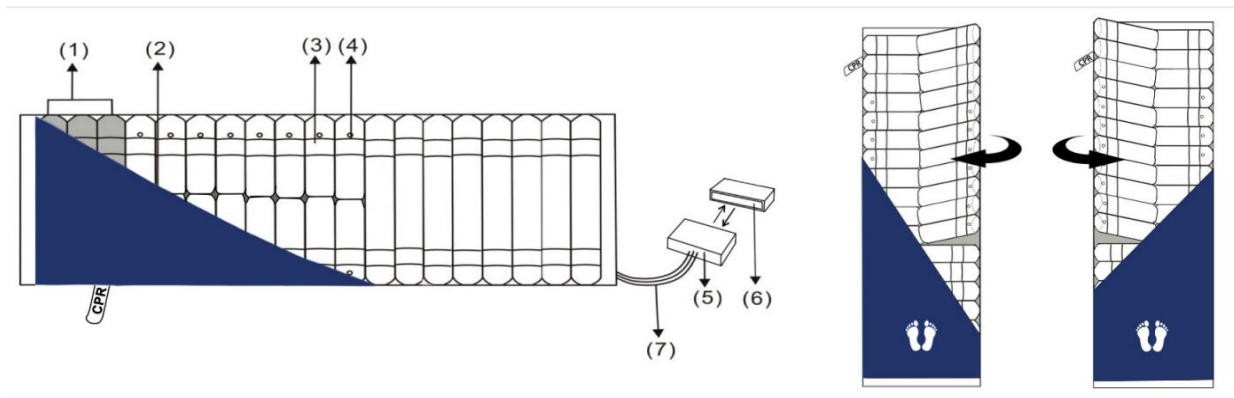

This key is: lock key (no operation within 3 minutes after startup, automatic lock, long press for 1.5 seconds, lock or unlock

This key is to release the alarm key (when the power is cut off abnormally, a long Bi--- alarm sound , and press the key to release the alarm. When pressure can't reach to 27mmhg within 4 minutes when it enters A or B large bayonet from ab small bayonet in normal alternation, (BI, BI....) The air leakage alarm will sound. After the alarm is removed, the 4-minute alarm model test room will be reset

Static: two tubes are inflated at the same time, the air pressure is 40mmhg, pressure fixed , and the digital LCD displays "--". won't back to alternating automatic . counting from static time, if pressure not arrive to 27mmhg within 4 minutes, and alarming (BI, BI...) . when the air pump enters the normal pressure (27mmhg), when pressure drops below 27mmhg, and can't back to 27mmhg within 4 minutes, and alarming (BI, BI...) . The air leakage alarm will sound. After the alarm is removed, the 4-minute alarm model test room will be reset

This key is: head and back raise , (press for raise, static mode pressure adjustable , raising mode at the same time. other functions cannot be realized, but it can be used at the same time with foot lifting. When the pressure of this function does not exceed 27mmhg within 30 minutes, the low-pressure alarm will be start. When the air pump enters the normal pressure (27mmhg), the pressure of the air pump keep drop below 27mmhg, and the pressure rise does not reach 27mmhg within 4 minutes, and the intermittent (Bi Bi...) alarm start. After the alarm is removed, the 4-minute alarm model will be reset

Infrared receiver

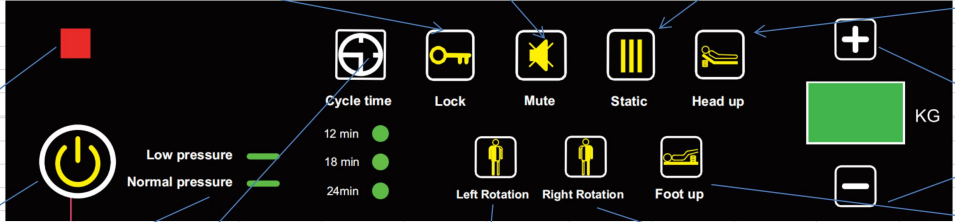

This key is the pressure adjustment key. Press +-, jump every 1 kg, and long press to increase and decrease quickly. Setup as kg or lb, initially : 120kg (reference as below table) (when pressure exceeds the setting number + 5mmhg, pump stops working, when below set up number , pump restart working).

on / off key

low/normal pressure indication light : pressure lower below 27MMh, red light , pressure reach to 27MMh green light working or flashing

Cycle time : 6/9/12 mins deflating and inflating cycle

left roataion. (left roation , static and pressure adjustable mode. other functions not available , but can be working with right rotation in same time. within 20mins pressure not reach to 27MMHG will be alarming , when pressure below 27mmHg, within 4mins not back to 27MMHG , start alarming (Bi Bi.....) air leak alarm start. After the alarm is removed, the 4-minute alarm model will be reset

right roataion. (right roation , static and pressure adjustable mode. other functions not available . but can be working with left rotation in same time. within 20mins pressure not reach to 27MMHG will be alarming , when pressure below 27mmHg, within 4mins not back to 27MMHG , start alarming (Bi Bi.....) air leak alarm start. After the alarm is removed, the 4-minute alarm model will be reset

press left and right rotation both , means left rotation 40 mins then right rotation 40mins alternating . Static and pressure adjustable . other functions not available , . within 20mins pressure not reach to 27MMHG will be alarming

foot lifting , static and pressure adjustable . other function not available . But it can be work in same time with head/back raising function .within 20mins pressure not reach to 27MMHG will be alarming , when pressure below 27mmHg, within 4mins not back to 27MMHG , start alarming (Bi Bi.....) air leak alarm start. After the alarm is removed, the 4-minute alarm model will be reset