

RollerSlide

SystemRoMedic™



User manual - English

Bruksanvisning - Svenska

Brukermanual - Norsk

Brugsvejledning - Dansk

Käyttöohje - Suomi

Gebrauchsanweisung - Deutsch

Handleiding - Nederlands

Manuel utilisateur - Français

Manuale utente - Italiano

Manual de usuario - Español

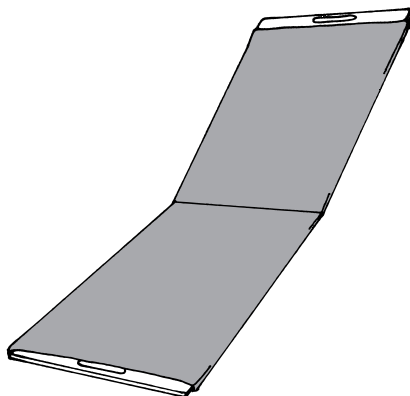

REF

9120 9148

9110 9158

9145 9170

9155 9175



SWL: 120-300 kg/265-661 lbs

Table of contents

English	3-4
Svenska	5-6
Norsk	7-8
Danske	9-10
Suomi	11-12
Deutsch	13-14
Netherlands	15-16
Français	17-18
Italiano	19-20
Español	21-22

Size and Accessories	23
-----------------------------------	----

Differences in height can pose a big problem. And sometimes it is difficult to get close enough to ensure smooth transfers for both users and caregivers. RollerSlide is used for supine transfers of inert users between beds and an x-ray or operating tables, shower trolleys, ambulance stretchers or similar. RollerSlide bridges gaps and moves with the user during the transfer.

RollerSlide is a padded sliding board with a sliding cover made from ULF (Ultra Low Friction), Handicare's own sophisticated sliding material. The sliding cover slides round the board during transfer, reducing the friction under the user and thereby facilitating a sliding transfer without unnecessary lifting for the caregivers. RollerSlide also ensures very gentle transfers for users who are injured or very sensitive to pain.



Check Safety

Visual inspection

Check the condition and function of the assistive device regularly. Always inspect the product after laundering. Check to ensure that seams and material are free from damage. Check to ensure that fabric is not worn or faded. If there are signs of wear, the product must be discarded.

Stability test

Carefully bend the assistive device to check strength and durability. The mat should be both elastic and rigid. Discard the EasyGlide when its strength and durability are diminished.

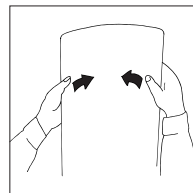

Always read the user manual

Always read the user manuals for all assistive devices used during a transfer.

Keep the user manual where it is accessible to users of the product.

Always make sure that you have the right version of the user manual.

The most recent editions of user manuals are available for downloading from our website, www.handicare.com.

Important information

RollerSlide must always be removed before x-raying, but RollerSlide Light can be left under the user during x-raying.
Do not leave the user unattended during a transfer situation.

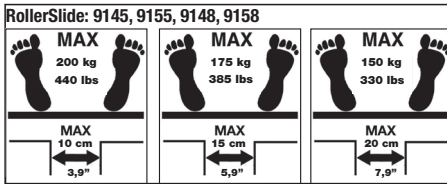
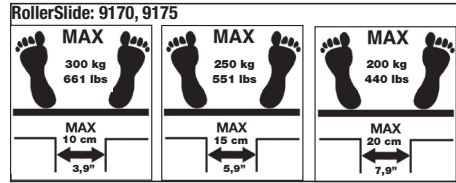
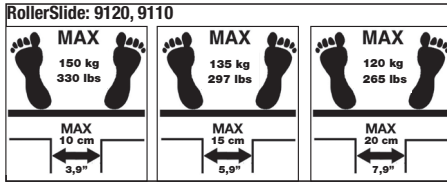

Placement/removal of RollerSlide

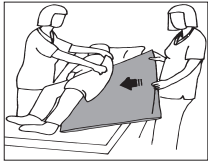

Lean the user to one side and guide the RollerSlide in under 1/3 of the body. To remove, lean the user to one side and pull out the RollerSlide.

Using RollerSlide

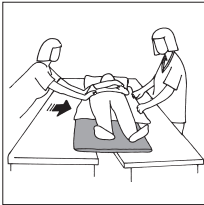

Caregivers should work on either side of the user, and push and pull while standing in a walking stance. Distance between underlying surfaces must not exceed 20 cm.

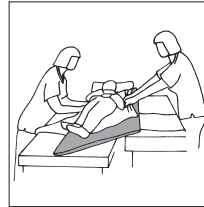

Roller Slide can also be used where there is a minor difference in height between the underlying surfaces.

Material

Polyamid, Nylon

Care of the product

RollerSlide board: Clean with disinfectant.



The sliding cover can be machine laundered. Do not use fabric softener. To ensure maximum material life, hang dry or tumble dry on low heat.

 Medical Device Class I

The product complies with the requirements of the Medical Devices Directive 93/42/EEC.

Contact your local distributor if you have any questions about the product and its use. See www.handicare.com for a complete list of distributors.

Expected lifetime

Up to 10 years of normal use

Size & Accessories

Art.no.	Size	Model	Sliding cover	Disposable cover
9120	175 x 50	Light	9136	9138
9110	85 x 50	Light	9156	9168
9145	175 x 50		9136	9138
9155	85 x 50		9156	9168
9148	175 x 50	Flexi	9136	9138
9158	85 x 50	Flexi	9156	9168
9170	175 x 60	Flexi	9172	
9175	85 x 60	Flexi	9177	

Simple solutions for great results

SystemRoMedic™ is the name of Handicare's unique easy transfer concept, the market's widest and most comprehensive range of clever, easy-to-use and safe transfer and lifting aids designed to make life easier, both for the user and for the caregiver. SystemRoMedic™ is a complete solution that provides for the majority of patient transfer or manual handling requirements. From the simplest to the most complex scenarios, from the lightest to the heaviest. The concept encompasses assistive devices for four different categories of transfers:

- Transfer, assistive devices for manual transfers of users between two locations.
- Positioning, assistive devices for manual repositioning of users within the same location.
- Support, assistive devices for mobility support e.g., during sit-to-stand or gait training.
- Lifting, assistive devices for manual and mechanical lifting of users.

Improved work environment, improved quality of care and cost savings

The philosophy behind SystemRoMedic™ is focused on the prevention and reduction of occupational injuries while allowing users to experience a greater sense of independence and dignity. Through a unique combination of training and a complete range of efficient transfer aids, SystemRoMedic™ offers improvement of both work environment and quality of care and, at the same time, achieves significant cost savings.

Always make sure that you have the correct version of the manual

The most recent version of all manuals are available for downloading at/from our website; www.handicare.com.

For questions about the product and its use

Please contact your local Handicare and SystemRoMedic™ representative. A complete list of all our partners with their contact details can be found on our website; www.handicare.com.

Handicare offers solutions and support to increase the independence of disabled or elderly people as well as to improve the convenience of those who are caring for them.

The Handicare Group is one of the leading healthcare companies in Europe with its own manufacturing organizations and sales companies in Norway, Sweden, Denmark, Germany, the Netherlands, Great Britain, France, China, Canada and the USA. Handicare's products are also distributed by partners in more than 40 countries worldwide. Our wide range of high-quality products includes various manual and power wheelchairs, seating systems, scooters, a complete easy transfer system and other patient handling aids, stairlifts, car adaptations, rise and recline chairs, and bathing and toileting products.



handicare

Handicare AB
Maskinvägen 17
SE-972 54 Luleå , SWEDEN
Tel: +46 (0)8-557 62 200
Fax: +46 (0)8-557 62 299
E-mail: info@handicare.se
www.handicare.com